

# INSTRUCTION MANUAL



Multimatica



LILIENTHAL BERLIN

# TABLE OF CONTENTS

---

Introducing the Multimatica .....	03
Setting the Time, Day, and Date .....	04
The 24-Hour Display .....	06
Technical Specifications .....	07
Changing the Straps .....	08
Care Instructions .....	09
Warranty .....	10
Recycling and Disposal .....	11
Contact .....	12

Note: For illustration purposes, this manual uses images of the All Black Edition.

## INTRODUCING THE MULTIMATICA

*Elegance meets functionality – with the Multimatica, you'll always be on time!*

---

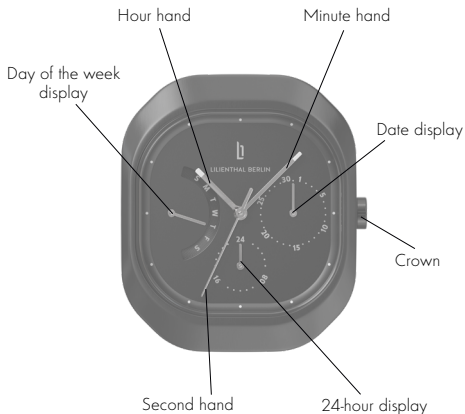

## SETTING THE TIME, DAY, AND DATE

*It all starts with the right settings.  
You only need the crown for this!*

---

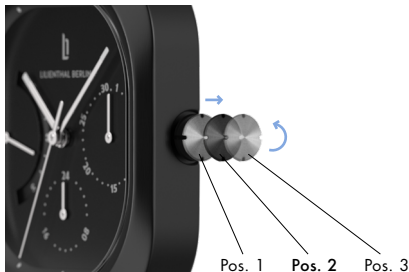

### To set the date:

1. Select the middle crown position (Pos. 2).
2. Turn the crown counterclockwise to the current date.

Please note: Do not set the date between 10 PM and 2 AM, as the day might not change correctly within the movement.

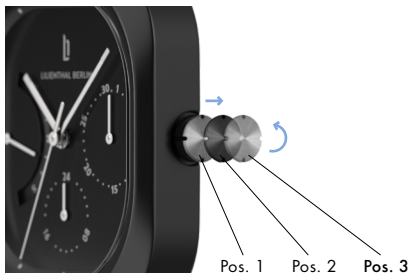

### **Setting the time and day of the week:**

1. Pull out the crown (Pos. 3).
2. Turn the crown clockwise until you reach the current day of the week.
3. Continue turning the crown until you reach the correct time. Make sure to use the 24-hour display to determine AM or PM (see next page).
4. Everything set? Push the crown back in (Pos. 1).

## THE 24-HOUR DISPLAY

*A day has 24 hours.*

*The Multimatica displays all of them.*

---

The 24-hour display runs simultaneously with the main hour hand and shows the time from 0:00 to 24:00. When the hand is at the top, it is exactly midnight. When it is at the bottom, it is noon. This way, you can always keep track of the entire day.

## TECHNICAL SPECIFICATIONS

*We only use the best components for the Multimatica. These are:*

---

<b>Movement:</b>	Multifunctional quartz movement
<b>Caliber:</b>	VH83A-M
<b>Case material:</b>	316L surgical steel
<b>Case size:</b>	36,25 x 30,75 x 7,60 mm
<b>Glass:</b>	Sapphire-hardened mineral glass
<b>Water resistance:</b>	3 bar

## CHANGING THE STRAPS

*If you think your watch needs a new look,  
just change the strap!*

---

To change the strap, push the small pin in the band inward (1). This shortens the bar and allows you to remove the band (2). To reattach it, pull the pin back and insert the bar into the holes in the case (3).

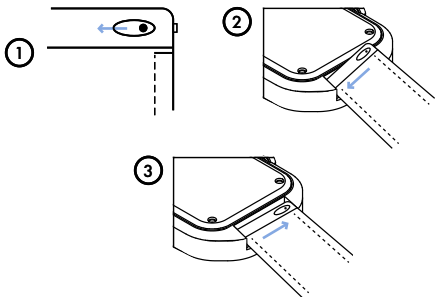

## CARE INSTRUCTIONS

*Your watch is quite easy to handle.*

*However, there are a few things to keep in mind.*

---

With a water resistance of 3 bar, it is well protected against water splashes, but it should not get too wet. If the battery runs out of power, simply take the watch to your trusted jeweler or watchmaker. The professional will replace the battery in no time! Our natural leather straps develop a fine patina over time, making them unique pieces! Dust and dirt can be removed with a slightly damp cloth. However, the straps should not get too wet. The stainless steel straps, on the other hand, handle moisture without any problems.

## WARRANTY

*We want to make you feel confident  
with your new watch*

---

We offer you a 24-month warranty. If there is a material or manufacturing defect within this time, it is best to contact our customer service directly. We will take care of it quickly and without fuss, so we can all be happy again!

## RECYCLING & DISPOSAL

*And if it ever comes to an end?*

---

Used electrical devices and batteries must not be disposed of in household waste but must be taken to authorized collection points. This ensures environmentally friendly disposal and reuse of the components. Thank you!



## ADDRESS

---

**Lilienthal Lifestyle GmbH**  
Boxhagener Straße 78  
10245 Berlin Germany

<https://www.lilienthal.berlin/en>

<https://www.lilienthal.berlin/uk>

<https://lilienthal-berlin.com>



LILIENTHAL BERLIN